

STAINLESS STEEL GROOVED COUPLINGS AND FITTINGS

*S-10
SINCE 1973*

*ISO
9001*



DUCCO

大可牌

DUCCO 牌不鏽鋼溝槽式機械接頭及管件的材質及特性

1. 卡箍

DUCCO 牌不鏽鋼溝槽式機械接頭適用於壓力管線。在下列幾種情況本產品都非常適用：

- (1) 管線因為溫度變化產生的熱脹冷縮或是偏斜
- (2) 地震的震動
- (3) 任何其他因素引起的波動

本產品採精密式不鏽鋼脫蠟鑄造，材質符合下列標準

- (1) **SS304** 符合 **ASTM A351 CF8** 標準
- (2) **SS316** 符合 **ASTM A351 CF8M** 標準
- (3) **Duplex** 符合 **ASTM A890 4A** 標準



2. 墊圈

本公司提供多樣化的橡膠墊圈以滿足客戶因不同流體、溫度、與適用性的選擇

A. EPDM：一般冷熱水，蒸氣、化學、食品的管線。不適用於碳氫化合物及石油的管線。
耐溫：-30°C ~+ 110°C

B. Nitrile：一般使用在石油、油性溶劑及酸性氧化液。耐溫：-20°C ~+ 80°C

C. Neoprene：一般使用在酸性稀釋液及潤滑油。耐溫：-0°C ~+ 80°C

D. Silicone：一般使用在乾熱空氣、高溫的化學溶劑及食品管線。
耐溫：-20°C ~+ 180°C

3. 螺絲及螺帽

本公司使用高拉力魚尾螺絲組，材質符合 **ASTM A193TYPE 304&316** 的標準，最低抗拉強度為 **75,000PSI**

4. 溝槽式不鏽鋼管件

本產品採精密式不鏽鋼脫蠟鑄造或高張力之 **SUS304**，材質部分符合 **ASTM A403 SUS 304 & 316** 標準。

耐壓 **300PSI** 以上。管件尺寸請參照後方型錄



CERTIFICATE

This is to certify that

Gentler Industrial Co., Ltd.
No. 101, Lane 279, Jen Ai Road, Cheng Guang
Ta Liao District, Kaohsiung City, Taiwan

has implemented and maintains a **Quality Management System**.

Scope:
The design and manufacture of rubber gasketed couplings, fittings and disc-ion fittings.

Through an audit, documented in a report, it was verified that the management system fulfills the requirements of the following standard:

ISO 9001 : 2008

Certificate registration no. 2006112 QM08
Date of original certification 1998-07-28
Date of revision 2012-11-22
Date of certification 2012-11-22
Valid until 2015-11-21

UL DQS Inc.
Joseph Han
General Manager

Certification Body: UL 2002 Inc., 1133 West Lake Street, Room 240, Buffalo Grove, IL 60089 USA
Issuing Office: UL 2002 (Taiwan) Inc., 9F, 2F, Yuan Hsin Cyber Plaza, Feng Yuan City, Taichung City, Taiwan 408

131223 FDNPMH49769 - Drinking Water System Components

UL ONLINE CERTIFICATIONS DIRECTORY

FDNP.MH49769
Drinking Water System Components

[Page Bottom](#)

Drinking Water System Components

[See General Information for Drinking Water System Components](#)

GENTLER INDUSTRIAL CO LTD MH49769
586 CHUNG HSIAD E RD SEC 5
TAIPEI, TAIWAN

Plant at: Kaohsiung City, Taiwan

NSF/ANSI 61

Pipes and Related Products

Trade Dsg	Water Contact Temp. (°C)	Water Contact Mat
"Couplings"		
Stainless Steel Couplings 1"-12"	60	Silicone or EPDM Rubber
"Fittings"		
Stainless Steel Fittings 2"-12"	60	Stainless Steel

Last Updated on 2013-12-02

Questions? [Print this page](#) [Terms of Use](#) [Page Top](#)

When the UL Leaf Mark is on the product, or when the word "Environment" is included in the UL Mark, please search the UL Environment database for additional information regarding this product's certification.

The appearance of a company's name or product in this database does not in itself assure that products so identified have been manufactured under UL's Follow-Up Service. Only those products bearing the UL Mark should be considered to be Certified and covered under UL's Follow-Up Service. Always look for the Mark on the product.

UL permits the reproduction of the material contained in the Online Certification Directory subject to the following conditions: 1. The Guide Information, Assemblies, Constructions, Designs, Systems, and/or Certifications (files) must be presented in their entirety and in a non-misleading manner, without any manipulation of the data (or drawings); 2. The statement "Reprinted from the Online Certifications Directory with permission from UL" must appear adjacent to the extracted material. In addition, the reprinted material must include a copyright notice in the following format: "© 2013 UL LLC".

GT-402S 不鏽鋼溝槽式機械接頭 撓性型式

DUCCO 牌不鏽鋼溝槽式機械接頭適用於壓力管線。在下列幾種狀況本產品都適用：(1) 管線因為溫度變化產生的熱脹冷縮或是偏斜 (2) 地震的震動 (3) 任何其他因素引起的波動。

本產品適用於 SCH. 5S 至 40S 的不鏽鋼管以及其他用途。本產品材質符合下列標準：(1) SS304 符合 ASTM A351 CF8 標準 (2) SS316 符合 ASTM A351 CF8M 標準 (3) Duplex 符合 ASTM A890 4A 標準。本產品的抗壓強度為 300PSI。(SS316 溝槽式機械接頭可選用 SS304 或 SS316 的螺絲組)

GT-402S
GT-422S

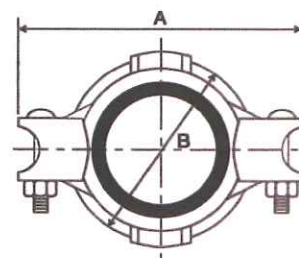
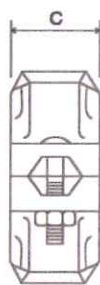

STAINLESS STANDARD GROOVED COUPLING

PIPE		DIMENSION			BOLT SIZE		Working Pressure Max. PSI	Allowable Pipe end Separation Inches/mm	DEFLECTION	
Size Inches mm	O.D Inches mm	A mm	B mm	C mm	NO.	Size Lengths Inches			Degress per Coupling	Inches per 20' pipe Length Inches/mm
1 25	1.315 33.4	94	54	42	2	3/8*1-3/4	300	0-1/8 0-3.2	4°-19'	18 457.2
1 1/4 32	1.660 42.4	102	63	43	2	3/8*1-3/4	300	0-1/8 0-3.2	3°-46'	15.8 401.3
1 1/2 40	1.900 48.3	108	70	44	2	3/8*1-3/4	300	0-1/8 0-3.2	3°-11'	13.4 340.3
2 50	2.375 60.3	128	83	44	2	3/8*2	300	0-1/8 0-3.2	2°-20'	9.7 246.4
2 1/2 65	2.875 73.0	144	94	44	2	3/8*2	300	0-1/8 0-3.2	2°-10'	9.0 228.6
2 1/2 65	3.000 76.2	147	97	44	2	3/8*2	300	0-1/8 0-3.2	2°-5'	8.7 221.0
3 80	3.500 88.9	160	110	45	2	1/2*2-1/2	300	0-1/8 0-3.2	1°-47'	7.4 188.0
4 100	4.500 114.3	194	140	49	2	1/2*2-3/4	300	0-1/4 0-6.4	3°-0'	12.6 320.0
5 125 A	5.563 141.3	222	169	49	2	1/2*2-3/4	300	0-1/4 0-6.4	2°-30'	10.4 264.2
5 125	5.500 139.7	220	168	49	2	1/2*2-3/4	300	0-1/4 0-6.4	2°-30'	10.4 264.2
6 150	6.500 165.1	258	195	51	2	5/8*3-1/4	300	0-1/4 0-6.4	2°-24'	10.1 265.5
6 150 A	6.625 168.3	261	198	51	2	5/8*3-1/4	300	0-1/4 0-6.4	2°-22'	9.9 251.5
8 200	8.625 219.1	312	251	60	2	5/8*3-1/4	250	0-1/4 0-6.4	1°-40'	7.0 177.8
8 J 200	8.515 216.3	309	248	60	2	5/8*3-1/4	250	0-1/4 0-6.4	1°-40'	7.0 177.8
10 J 250	10.528 267.4	364	306	62	2	3/4*4-1/4	175	0-1/4 0-6.4	1°-20'	5.6 142
10 250	10.75 273	370	311	62	2	3/4*4-1/4	175	0-1/4 0-6.4	1°-20'	5.6 142

*10" with hexagon head bolts.

GT-402SR 不鏽鋼溝槽式機械接頭 剛性型式

剛性型式的機械接頭提供一般及大尺寸的不鏽鋼管堅固的夾持，以抵抗扭轉與彎曲負荷。

本產品適用於 SCH. 10S 至 40 及 BS 標準的不鏽鋼管以及其他用途。材質符合下列標準：

- (1) SS304 符合 ASTM A351 CF8 標準 (2) SS316 符合 ASTM A351 CF8M 標準 (3) Duplex 符合 ASTM A890 4A 標準。本產品的抗壓強度為 300PSI。(SS316 溝槽式機械接頭可選用 SS304 或 SS316 的螺絲組)

STAINLESS RIGID GROOVED COUPLING

GT-402SR
GT-422SR



PIPE		DIMENSION			BOLT SIZE		Max. Pressure PSI	Allowable Pipe end Separation Inches/mm	DEFLECTION	
Size Inches mm	O.D Inches mm	A mm	B mm	C mm	NO.	Size Lengths Inches			Degress per Coupling	Inches per 20' pipe Length Inches/mm
2	2.375	128	83	45	2	3/8*2	300	0-1/8	2°-20'	9.7
50	60.3							0-3.2		246.4
2 1/2	2.875	144	94	45	2	3/8*2	300	0-1/8	2°-10'	9.0
65	73.0							0-3.2		228.6
2 1/2	3.000	147	97	45	2	3/8*2	300	0-1/8	2°-5'	8.7
65	76.2							0-3.2		221.0
3	3.500	160	110	45	2	1/2*2-1/2	300	0-1/8	1°-47'	7.4
80	88.9							0-3.2		188.0
4	4.500	194	140	49	2	1/2*2-3/4	300	0-1/4	3°-0'	12.6
100	114.3							0-6.4		320.0
5	5.563	222	169	49	2	1/2*2-3/4	300	0-1/4	2°-30'	10.4
125	141.3							0-6.4		264.2
5	5.500	220	168	49	2	1/2*2-3/4	300	0-1/4	2°-30'	10.4
125	139.7							0-6.4		264.2
6	6.500	258	195	51	2	5/8*3-1/4	300	0-1/4	2°-24'	10.1
150	165.1							0-6.4		265.5
6	6.625	261	198	51	2	5/8*3-1/4	300	0-1/4	2°-22'	9.9
150	168.3							0-6.4		251.5
8	8.625	281	211	51	2	5/8*3-1/4	250	0-1/4	1°-40'	7.0
200	217.1							0-6.4		177.8
8	8.500	278	208	51	2	5/8*3-1/4	250	0-1/4	1°-40'	7.0
200 J	214.3							0-6.4		177.8
10	10.728	309	248	51	2	5/8*3-1/4	175	0-1/4	1°-20'	5.6
250 J	267.4							0-6.4		142
10	10.75	307	246	51	2	5/8*3-1/4	175	0-1/4	1°-20'	5.6
250	266.7							0-6.4		142

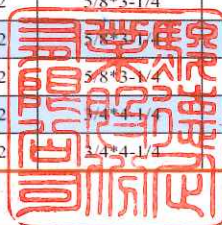

10" with hexagon head bolts.

GT-402SH 不鏽鋼溝槽式重型機械接頭

GT-402SH 不鏽鋼溝槽式重型機械接頭

本產品適用於和緩的高壓力管路。高流速，大尺寸，以及壓力較大的時候 (600PSI)，都適合採用重型機械接頭。本產品適用於 SCH. 20S 至 80S 的不鏽鋼管。材質符合下列標準：

- (1) SS304 符合 ASTM A351 CF8 標準 (2) SS316 符合 ASTM A351 CF8M 標準。本產品的抗壓強度為 600PSI。(SS316 溝槽式機械接頭可選用 SS304 或 SS316 的螺絲組)

STAINLESS HEAVY DUTY GROOVED COUPLING

GT-402SH

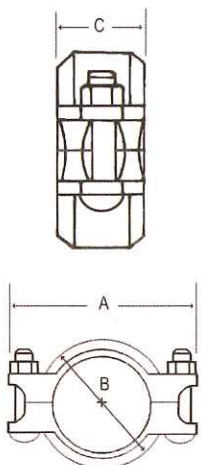

PIPE		DIMENSION			BOLT SIZE		Max. Pressure PSI	DEFLECTION	
Size Inches mm	O.D Inches mm	A mm	B mm	C mm	NO.	Size Lengths Inches		Degress per Coupling	Inches per 20' pipe Length Inches/mm
2	2.375	130	85	45	2	3/8*2	600	2°-20'	9.7
50	60.3								246.4
2 1/2	2.875	150	96	45	2	1/2*2-1/2	600	2°-10'	9.0
65A	73.0								228.6
2 1/2	3.000	153	99	45	2	1/2*2-1/2	600	2°-5'	8.7
65	76.2								221.0
3	3.500	163	113	45	2	1/2*2-3/4	600	1°-47'	7.4
80	88.9								188.0
4	4.500	202	144	50	2	5/8*3-1/4	600	3°-0'	12.6
100	114.3								320.0
5	5.563	230	174	51	2	5/8*3-1/4	600	2°-30'	10.4
125A	141.3								264.2
5	5.500	228	172	51	2	5/8*3-1/4	600	2°-30'	10.4
125	139.7								264.2
6	6.500	266	199	52	2	3/4*4-1/4	500	2°-24'	10.1
150	165.1								265.5
6	6.625	279	202	52	2	3/4*4-1/4	500	2°-22'	9.9
150A	168.3								251.5

*6" with hexagon head bolts.

溝槽式不鏽鋼管件

大可牌產品採一體成型精密鑄造或 SUS 304 高張力鋼板製成，材質符合 ASTM A403 SUS 304 & 306、JIS B2313 WP 304 & 316 標準 (Duplex 符合 ASTM A890 4A 標準)。耐壓 300PSI 以上。大部分常見的產品及尺寸都在下列目錄中，其他樣式的管件也可依客戶要求生產，詳情請與本公司聯絡。



PIPE Size Inches mm	PIPE O.D. Inches mm	GT-602S 90° ELBOWS	GT-604S 45° ELBOWS	GT-611S TEE	GT-618S CAP	GT-630S ADAPTOR
		C to E mm	C to E mm	C to E mm	L mm	L mm
1 1/2 40	1.900 48.3	64	38	64	-	OCT 60
2 50	2.375 60.3	70	50	70	36	OCT 64
2 1/2 65	2.875 73.0	76	57	76	45	OCT 70
2 1/2 65	3.000 76.2	76	57	76	45	OCT 70
3 80	3.500 88.9	86	64	86	45	DEC 76
4 100	4.500 114.3	102	76	102	50	DEC 83
5 125	5.500 139.7	124	78	124	57	-
5 125	5.563 141.3	124	78	124	57	-
6 150	6.500 165.1	140	83	140	60	-
6 150	6.625 168.3	140	83	140	60	-
8 200J	8.515 216.3	165	96	165	72	-
8 200	8.625 219.1	165	96	165	72	-
10 250J	10.528 267.4	190	114	190	72	-
10 250	10.75 273.0	190	114	190	72	-

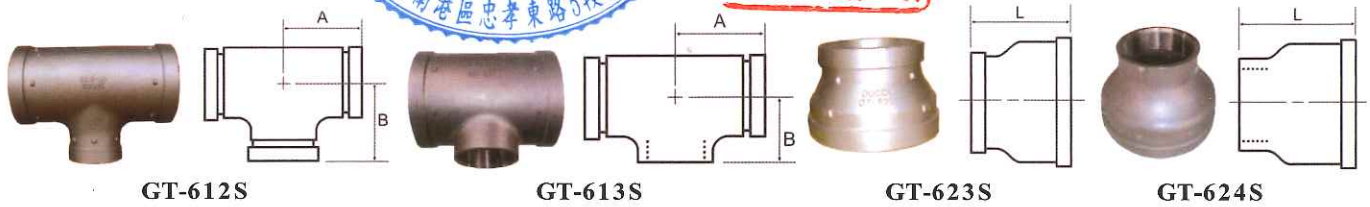
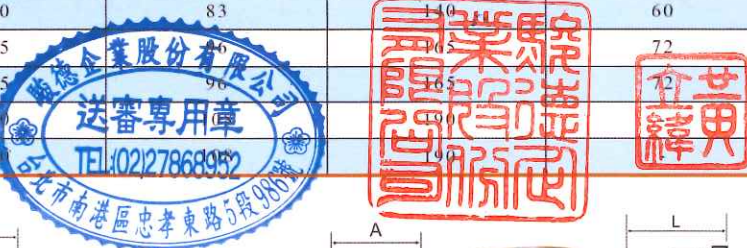

SIZE Inches mm	GT-612S Red.TEE		GT-613S Red.TEE. (THD)		GT-623S Con.Reducer	GT-624S Reducer (THD)
	A mm	B mm	A mm	B mm	L mm	L mm
2" * 1 1/2"	69	69	-	-	63.1	-
2 1/2" * 2"	76	76	73	56	63.1	58
3" * 2 1/2"	86	86	-	-	63.1	-
3" * 2"	86	86	75	62	76.2	60
4" * 3"	102	102	-	-	76.2	-
4" * 2 1/2"	95	102	-	-	89	-
4" * 2"	90	102	75	75	89	80
5" * 4"	124	124	-	-	89	-
5" * 3"	102	124	-	-	89	-
6" * 5"	-	-	-	-	102	-
6" * 4"	127	127	-	-	102	-
6" * 3"	108	127	-	-	114	-
6" * 2 1/2"	108	127	-	-	114	-
8" * 6"	152	152	-	-	127	-
8" * 4"	127	152	-	-	127	-
10" * 8"	-	-	-	-	127	-
10" * 6"	-	-	-	-	140	-

GT-426S 不鏽鋼溝槽式高徑法蘭

FIG.GT-426S



PIPE		Flange Dimension		Max. Working Pressure PSI	Bolt Dia.	No. of Bolt Holes (Elongation)
Size Inches mm	O.D Inches mm	A Inches mm	B Inches mm			
2" 50	2.375 60.3	6.30 160	2.375 60.3	300	5/8"	4
2-1/2" 65	3.000 76.2	7.125 181	2.375 60.3	300	5/8"	4
2-1/2" 65A	2.875 73	7.125 181	2.375 60.3	300	5/8"	4
3" 80	3.500 88.9	7.625 194	2.375 60.3	300	5/8"	8
4" 100	4.500 114.3	8.625 219	2.375 60.3	300	5/8"	8
5" 125	5.563 141.3	9.840 250	2.563 65.1	300	3/4"	8
6" 150	6.500 165.1	11.10 282	2.563 65.1	300	3/4"	8
6" 150A	6.625 168.3	11.10 282	2.563 65.1	300	3/4"	8
8" 200	8.625 219.1	13.30 338	3.000 76.2	300	3/4"	8

*Standard ANSI 150, JIS 10K, PN16, T/E, Availbel on Request Please Contact Gentler for detail.

GROOVED END PIPE SPECIFICATION (管徑規格)

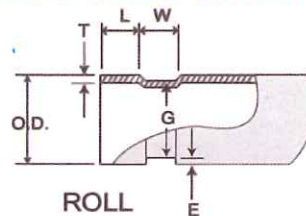
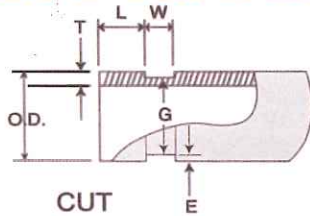

PIPE Size Inches mm	PIPE O.D Inches mm	Min. Thick Cut Inches/mm	Min. Thick Roll Inches/mm	L Width ±0.031 Inches ±0.8mm	G +0.000 Inches mm	W Width ±0.031 Inches ±0.8mm	E Inches mm (Ref)	Max. Allow Flare Inches/mm
1" 25	1.315 33.4	0.140 3.556	0.065 1.651	0.625 15.875	1.190-.015 30.226-.381	0.3125 7.937	0.063 1.600	1.365 34.67
1-1/4" 32	1.660 42.4	0.140 3.556	0.065 1.651	0.625 15.875	1.535-.015 38.989-.381	0.3125 7.937	0.063 1.600	1.740 44.20
1-1/2" 40	1.900 48.3	0.145 3.683	0.065 1.651	0.625 15.875	1.775-.015 45.085-.381	0.3125 7.937	0.063 1.600	1.980 50.29
2" 50	2.375 60.3	0.154 3.912	0.065 1.651	0.625 15.875	2.250-.015 57.150-.381	0.3125 7.937	0.063 1.600	2.455 62.38
2-1/2" 65	2.875 73.0	0.187 4.750	0.083 2.108	0.625 15.875	2.720-.018 69.088-.457	0.3125 7.937	0.078 1.981	2.955 75.06
2-1/2" 65	3.000 76.2	0.188 4.775	0.083 2.108	0.625 15.875	2.845-.018 72.263-.457	0.3125 7.937	0.078 1.981	3.080 78.23
3" 80	3.500 88.9	0.188 4.775	0.083 2.108	0.625 15.875	3.344-.018 84.938-.457	0.3125 7.937	0.078 1.981	3.580 90.93
4" 100	4.500 114.3	0.203 5.156	0.083 2.108	0.625 15.875	4.334-.020 110.084-.508	0.375 9.525	0.083 2.108	4.580 116.33
5" 125A	5.563 141.3	0.203 5.156	0.109 2.769	0.625 15.875	5.395-.02 137.033-.559	0.375 9.525	0.084 2.134	5.643 143.33
5" 125	5.500 139.7	0.203 5.156	0.109 2.769	0.625 15.875	5.332 135.433-.559	0.375 9.525	0.084 2.134	5.579 141.70
6" 150	6.500 165.1	0.219 5.563	0.109 2.769	0.625 15.875	6.330-.022 160.782-.559	0.375 9.525	0.085 2.159	6.600 167.64
6" 150 A	6.625 168.3	0.219 5.563	0.109 2.769	0.625 15.875	6.455-.022 163.957-.559	0.375 9.525	0.085 2.159	6.725 170.82
8" 200	8.625 219.1	0.238 6.045	0.109 2.769	0.750 19.050	8.441-.025 214.401-.686	0.437 11.10	0.092 2.337	8.745 222.12
8" 200 J	8.520 216.4	0.238 6.045	0.109 2.769	0.750 19.050	8.336-.025 211.734-.762	0.437 11.10	0.092 2.337	8.635 219.33
10" 250	10.75 273.0	0.250 6.350	0.134 3.404	0.750 19.050	10.562-.027 268.275-.686	0.500 12.70	0.094 2.388	10.875 276.23
10" 250 J	10.528 267.4	0.250 6.350	0.134 3.404	0.750 19.050	10.34-.027 262.6-.686	0.500 12.70	0.094 2.388	10.654 270.60
12" 300	12.75 323.9	0.279 7.087	0.156 3.962	0.750 19.050	12.531-.030 318.287-.762	0.500 12.70	0.109 2.769	12.875 327.03
12" 300 J	12.540 318.5	0.279 7.087	0.156 3.962	0.750 19.050	12.321-.030 313-.762	0.500 12.70	0.109 2.769	12.661 321.60

SG-CV 不銹鋼橫式逆止閥 溝槽式 300PSI
Stainless Steel Check Valve Groove End

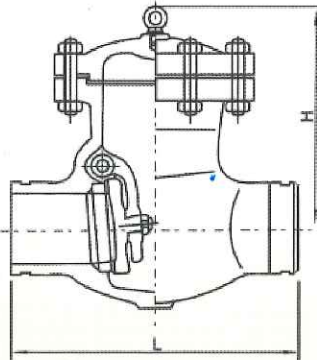

閥座	水壓	32 kgf/cm ²
	氣壓	6 kgf/cm ²
閥體	水壓	24 kgf/cm ²

單位：mm

SIZE	2"	2-1/2"	3"	4"	5"	6"
L	200	212	237	290	325	350
H	130	148	160	185	215	247

零件 PART	材質 MATERIAL
閥體 Body	Stainless Steel
閥蓋 Bonnet	Stainless Steel
閥盤 Disc	Stainless Steel
銷 Pin	Stainless Steel

SG-YT 不銹鋼 Y 型過濾器 溝槽式 300PSI
Stainless Steel Y-Strainer Groove End

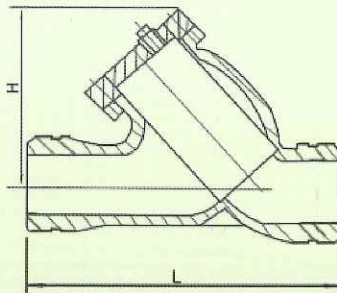
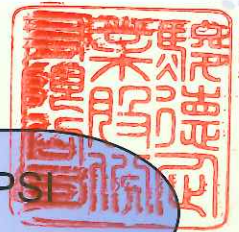

閥體	水壓	32 kgf/cm ²
	氣壓	6 kgf/cm ²

單位：mm

SIZE	2"	2-1/2"	3"	4"	5"	6"
L	207	247	277	315	330	385
H	145	160	170	198	225	250

零件 PART	材質 MATERIAL
閥體 Body	Stainless Steel
閥蓋 Bonnet	Stainless Steel
過濾網 Screen	Stainless Steel
墊片 Gasket	PTFE
塞頭 Plug	Stainless Steel

SG-GV 2 不銹鋼昇桿閘門閥 溝槽式 300PSI
Stainless Steel Gate Valve Groove End (Rising Stem)

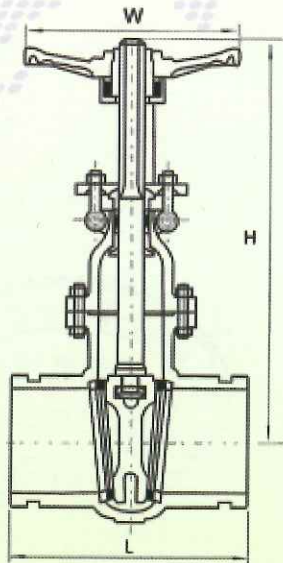

閥體	水壓	32 kgf/cm ²
閥座	水壓	24 kgf/cm ²
	氣壓	6 kgf/cm ²

零件 PART	材質 MATERIAL
閥體 Body	Stainless Steel
閥蓋 Bonnet	Stainless Steel
閥盤 Disc	Stainless Steel
閥桿 Stem	Stainless Steel
格蘭 Gland	Stainless Steel
迫緊 Packing	PTFE
手輪 Handwheel	D.I / S.S

單位：mm

SIZE	2"	2-1/2"	3"	4"	5"	6"
L	177	187	202	230	250	265
H	325	375	410	460	510	580
W	200	235	235	250	280	300

DUCCO



駿德企業股份有限公司
GENTLER INDUSTRIAL CO., LTD.

1F., No. 986, Sec. 5, Zhongxiao E. Rd., Nangang Dist.
 Taipei City 115 Taiwan (R.O.C.)

Tel:(02)26519252-3 Fax:886-2-27863294

E-mail:gtr542ht@ms18.hinet.net

<http://www.ducco.com.tw>



STAINLESS STEEL GROOVED END VALVE



300PSI 不銹鋼溝槽式蝶閥

GROOVED END BUTTERFLY VALVE 300PSI

Model: TC7107 TC7108

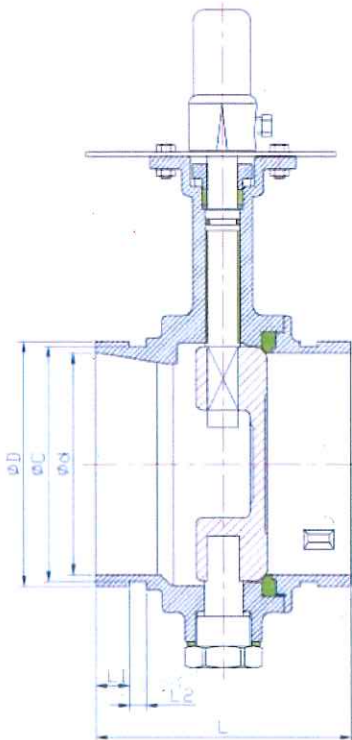
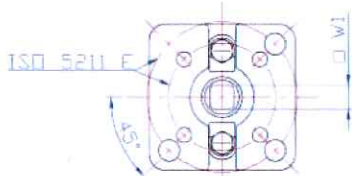
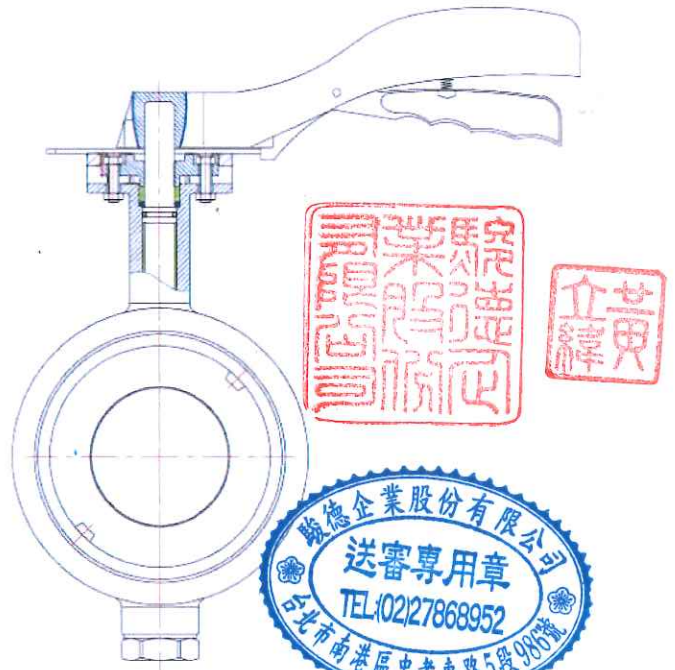

部件名稱 PART NAME	材質 MATERIAL	
	TC7107	TC7108
閥體 BODY	SCS13	SCS14
閥蓋 CAP	SCS13	SCS14
閥瓣 DISC	SCS13	SCS14
閥桿 STEM	SUS304	SUS316
閥座 SEAT	EPDM	
軸承 BEARINGS	PTFE	
O型墊片 O-RING	VITON	
大薄片 GASKE	SUS304	
中口 PACKING	PTFE	
牛筋 GLAND	SCS13	
螺母 NUT	SUS304	
螺栓 BOLT	SUS304	
手柄 LEVER	ALUMINM ALLOY	
大薄片 GASKE	PTFE	
閥桿 STEM	SUS304	SUS316

UNIT/mm

SIZE	d	D	C	L1	L2	L	E	W1	
2"	50	50	60.5	56.6	15.88	7.95	106	50-70	11
2 1/2"	65	61	76.1	72.2	15.88	7.95	111	50-70	11
3"	80	80	88.9	84.9	15.88	7.95	112	50-70	11
4"	100	101	114.3	110.0	15.88	9.53	119	50-70	11
5"	125	127	139.7	135.4	15.88	9.53	132	50-70	14
6"	150	150	165.1	160.7	15.88	9.53	135	50-70	14
8"	200	202	216.3	211.6	19.05	11.1	158	70-102	17

安裝方法

機械開槽式管配件及接頭是目前被世界上大部分地區廣泛使用於各種管線系統中最有效益及最經濟方便的一種。其安裝方法如下圖示

1. 將整組接頭，包括罩殼、封環及螺絲組備妥，所唯一需要的工具就是一支扳手。
2. 安裝前先將管子的端槽檢視一下，確定沒有毛邊及表面刮槽或不潔物，一切符合規格。
3. 將一般的橡膠用潤滑劑塗抹於封環使其置於二根管子端槽的中間。
4. 將罩殼至於封環上，套上螺絲組。
5. 轉動螺絲組，將兩邊螺帽平均鎖緊至罩殼相互緊密在一起。

Recommended Torque:

Bolt Size(Inches)	3/8	1/2	5/8	3/4
Torque(Ft.-Lbs)	25	40	60	80

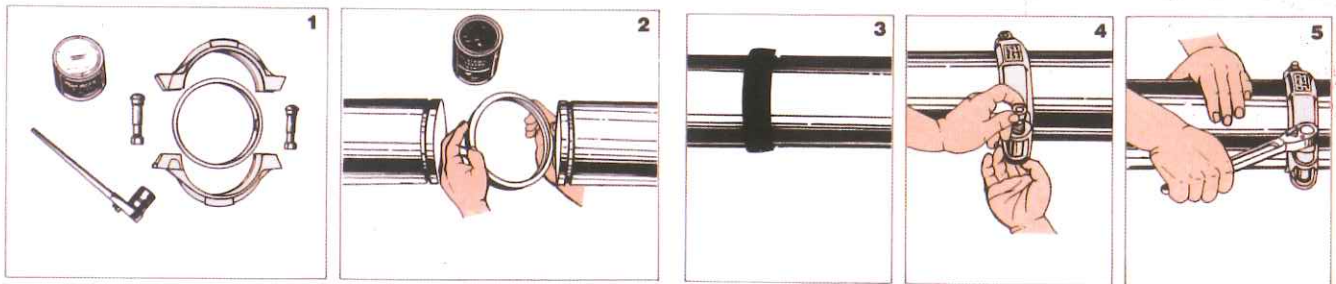

GROOVED MACHINE



MODEL:GT-905A

CAPACITY:
 SCH 40 PIPE 2"-8"
 BS B PIPE 2"-12"
 SCH 10 PIPE 2"-12"
 POWER SUPPLY:1HP MOTOR
 220V 50Hz
 SINGLE PHASE
 RPM: 29
 PARTS INCLUDING:
 PIPE STAND 1SET
 UPPER HEAD ROLLER: 2"-6"
 8"-12"
 BOTTOM HEAD ROLLER: 2"-4"
 3"-6"
 8"-12"
 TOTAL WEIGHT ABOUT: 109KGS

MODEL:GT-905AS

CAPACITY:
 SCH 40 PIPE 1"-8"
 BS B PIPE 1"-12"
 SCH 10 PIPE 1"-12"
 POWER SUPPLY:1HP MOTOR
 220V 50Hz
 SINGLE PHASE
 RPM: 29
 PARTS INCLUDING:
 PIPE STAND 1SET
 UPPER HEAD ROLLER: 1"-2"
 2"-6"
 8"-12"
 BOTTOM HEAD ROLLER: 1"-2"
 2"-3"
 3"-6"
 8"-12"
 TOTAL WEIGHT ABOUT: 112KGS



